





ATAC Solutions Ltd is a leading environmental engineering company based in Maidstone, United Kingdom.

ATAC Solutions is known for its state-of-the-art liquid collection fleet and its expertise in providing bespoke turnkey wastewater process solutions.

With a focus on sustainability and accreditation in ISO 9001 & ISO 14001, the company serves domestic and industrial clients across the South-East and London.



ATAC Solutions Ltd,  
Unit A9, Loc 8 Business Park, Ashford Road,  
Hollingbourne, Maidstone, England, ME17 1WR

 [atacsolutions.com](https://atacsolutions.com)  
 01622 882400



Axiom Water companies



Phone  
Fax

**STS 65/10**  
System: Submersible pump

**WILO**

Customer

Project

Customer no.

Project no.

Contact

Position no.

Care of

Location

Date

2012-07-16

Page 1 / 2

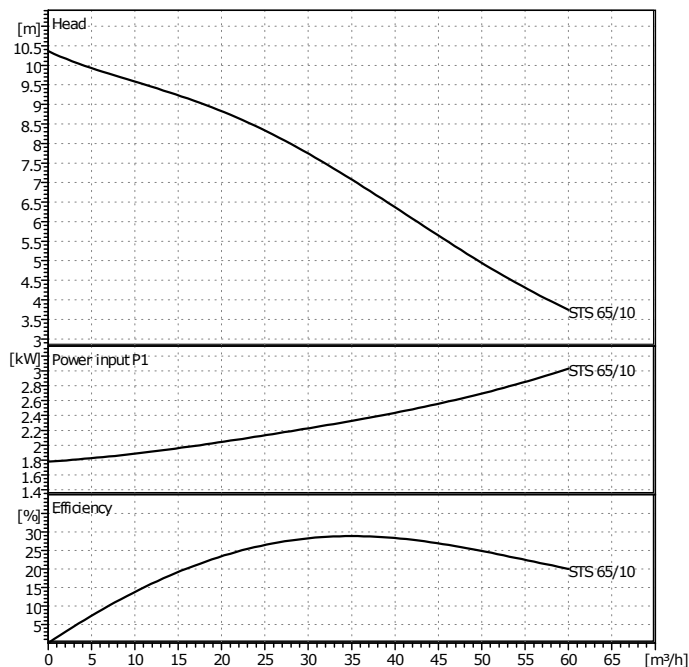

**Requested data**

Flow	0	m³/h
Head	0	m
Fluid	Water, pure	
Fluid temperature	20	°C
Density	0.9983	kg/dm³
Kinematic viscosity	1.005	mm²/s
Vapor pressure	0.02337	bar

**Pump data**

Make	WILO	
Type	STS 65/10	
Pumpe type	Single head pump	
Pressure rating	PN 10	
Min. fluid temperature	0	°C
Max. fluid temperature	40	°C

**Hydraulic data (duty point)**

Flow		m³/h
Head		m
Speed	0	1/min
Impeller size	110	mm

**Materials / Shaft seal**

Pump housing	Cast iron
Impeller	Cast iron
Shaft	1.0570
Mechanical seal, pump side	SiC-SiC
Static seals	NBR
Motor housing	1.4404

**Dimensions per pump**

mm

A	611						
B	716						

Suction side	-	/ PN 0	
Discharge side	DN65/80/	PN 0	
Weight	36		kg
Free passage	65		mm

**Motordata per Motor/Pump/**

Rated power P2	2.4	kW
Nominal speed	2900	1/min
Rated voltage	3~400 V, 50 Hz	
Max. current	5	A
Degree of protection	IP 68	
Permitted voltage tolerance	+/- 10%	

Item no. of standard version 6061739

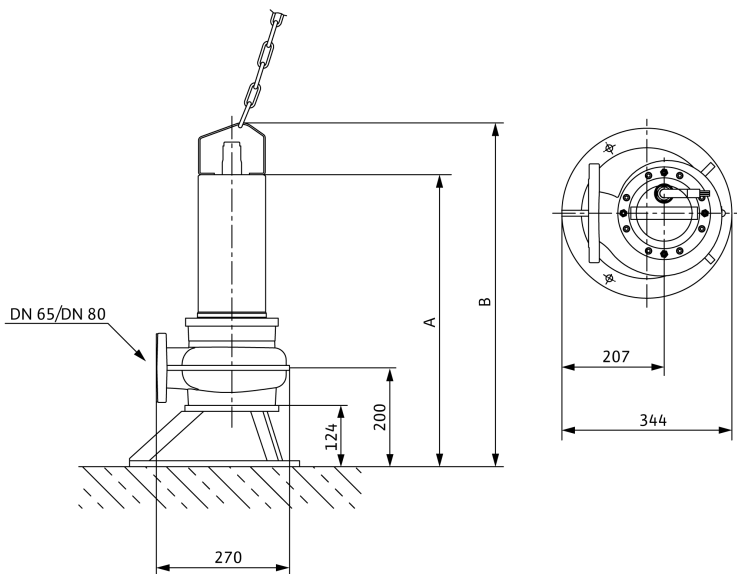

Phone Fax		<b>STS 65/10</b> System : Submersible pump			<div style="border: 1px solid black; padding: 5px; text-align: center;"> <b>WILO</b> </div>		
Customer Customer no. Contact Care of		Project Project no. Position no. Location			Page 2 / 2   Date 2012-07-16		

Standard							
Suction side		-					
Discharge side		DN65/80					

Dimensions		mm					
A	611						
B	716						